



Self Check-in Instructions

1. You can self check-in any time **after 3PM**
2. Use the Property Map on page 3 to locate guest parking as well as your room
 - Disregard signage to ring the bell (only applies to in-person check-ins or if you need bicycle storage – **DO NOT BRING BICYCLES INSIDE**)
 - Your room number is on your original reservation and “Welcome” email
3. You’ll find the room key in the door handle of your room
 - For rooms inside the Main Guest House:
 **ALWAYS BRING YOUR KEY WITH YOU** to prevent locking yourself out! These doors lock easily from the inside
4. Read the Guest Information card in your room – includes WIFI passcode and how to get in contact with your hosts, etc.
5. Once you have arrived, use the direct link found in your “Welcome” email (called Contactless Check-in). You can also use the following link but will need your 5 digit reservation # and phone number: <https://resnexus.com/l/HJgltV>
 - **5 digit reservation #** included in the “Welcome” email from us (not third party reservation #s)
 - **Phone number** (10 digit Can/US; some Int’l numbers may not work – please email us in this case)
6. Payment: your credit card will be charged for the full amount of your stay
7. Enjoy your stay!



Guest House Info

- ★ **Wi-Fi Passcode:** see Guest Information card in your room
- ★ **Housekeeping:** We will not be servicing your room during your stay. If you need anything just let us know
- ★ **Front Door** is always unlocked
- ★ **Lights** in lounge shut off at 9:30PM on a timer (please don't touch the lights)
- ★ **Backyard** closes at 9PM
- ★ **Quiet hours** after 9PM
- ★ **No smoking:** smoking is only permitted in the driving circle out front
- ★ **How to reach us:** If it's late or not urgent, you can text our cell phones. See Information Guide in your room for phone numbers. For urgent matters ring the doorbell outside
- ★ **Hot Beverage Area:** located in the Guest House lounge. Self-serve and always available. Fridge is shared so please be courteous to fellow guests and only store small items
- ★ **Check-out is at 11AM:** see instructions card in your room
- ★ **Pets:** pets are welcome in the Cottage and Studio Suites only. We have a host cat named Steve that does go inside the guest house.
- ★ **Bicycles:** Contact us so we can show you where to lock up your bike(s)



Property Map

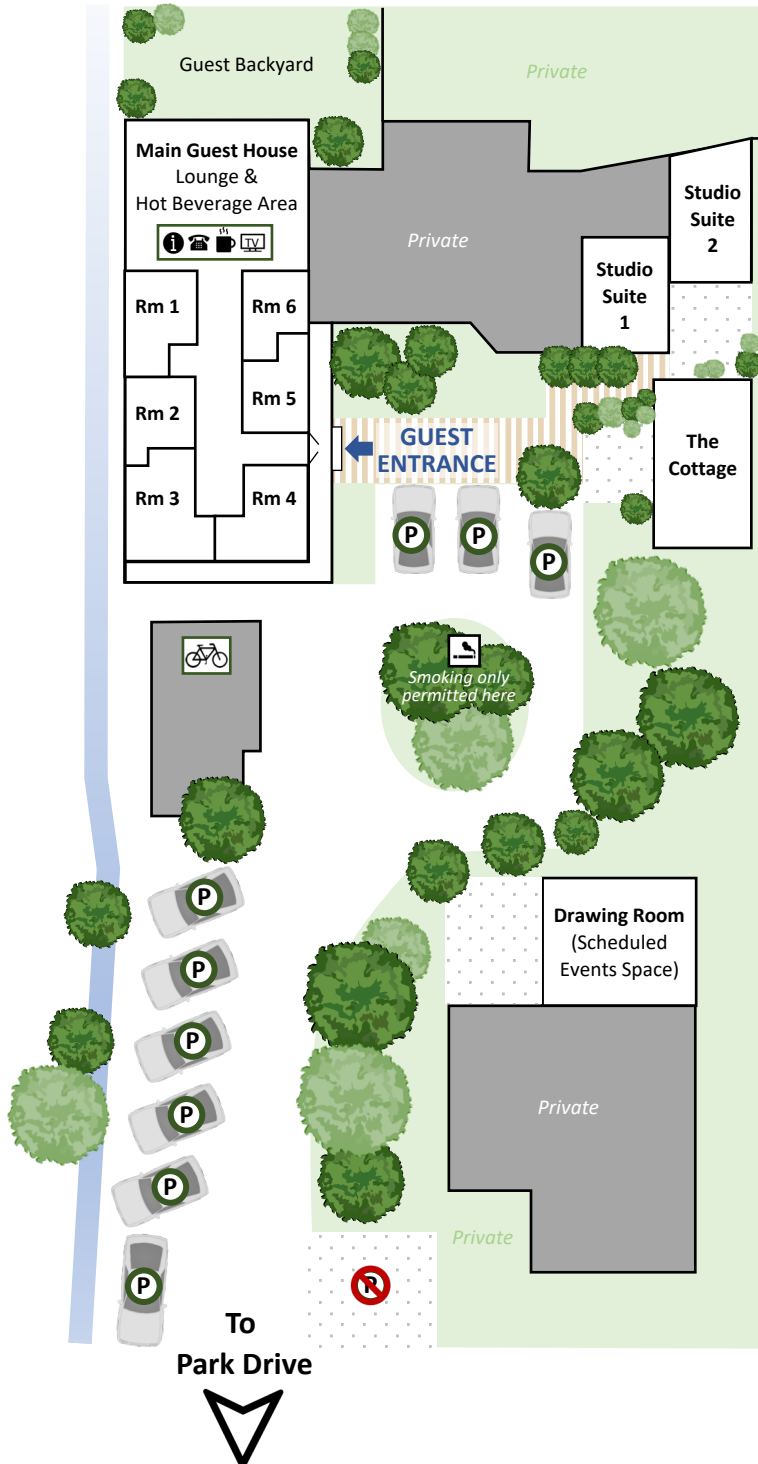



10 Minute Walk to Town

Follow highlighted shorter route to Ganges Village. ▲ indicates a community farm stand on Park Dr. – follow the pedestrian path beside it.

